

### AV-WALL-DT4i Overview

The AV-WALL-DT4i Dante Mic/Line Interface is a cost-effective wall box in an incredible small size of just 45x45mm.

The AV-WALL-DT4i offers 64dB of true preamp gains on 2 professional XLR Mic inputs and 40dB of gains at line level on a stereo mini Jack connector. All gains can be controlled remotely via network or locally via direct rotative push buttons per steps of 0.5dB.

The AV-WALL-DT4i is designed to fit into a single-gang junction box of only 45x45mm fitting small European format. AV-WALL-DT4i is PoE enabled and thus power, control and audio data connectivity is provided by a single CAT-5e/6 cable.

### Key Features

- 2x Microphone/Line inputs (1/2) with 64dB of gains between -24dB to 40dB controllable per step of 0.5dB via network or locally via rotative push button
- 2x XLR female connectors for the 2 Mic/Line (1/2)
- 2x +48V Phantom power, remotely or locally controllable for the Mic inputs
- 2x Line inputs (L/R) with 40dB of gains between -12dB to 28dB controllable per step of 0.5dB via network or locally via rotative push button
- 3.5mm mini Jack connector for the 2 Line (L/R) inputs
- Embedded rotative push button gives local control of any individual gains and to the 48V phantom power if remotely activated.
- 4x Dante channel transmitters working at selectable frequency of 44.1kHz, 48kHz, 88.2kHz and 96kHz
- Internal mixers allow sending 4 individual mixing of the 4 inputs (1, 2, L and R) to the 4 Dante channels
- Dedicated control page for monitoring and controlling all the parameters (gain, phantom power on each channel, preamp values, vu-meter)
- 802.3af compliant, the AV-WALL-4DTi can work and may be powered with any compliant PoE network switch
- Internal connector for Bluetooth extension wall plate



### Mechanical Specifications

45 x 45 x 50 mm: Size of the main box  
 Depth can be adjusted to fit near any wall size  
 Wall plate size may vary depending of the region

### AV-WALL-DT4i Applications

Any convenient, wall mounted Mic and Line to Dante network in Theatres, Convention centres, Hotel ballrooms, Corporate meeting rooms, Restaurants, Bars Sports facilities featuring any or all the following requirements:

- State of the art in quality/price ratio standard for professional Wall-Plate applications
- High quality microphones with fine steps of gain for Mic pre-amplification adjustments
- To fit in a small single-gang junction box included most of the European and Asian standards
- Quick local gain adjustment without any external computer
- Avoid using an unsightly external junction box to fix it in the wall
- 2 Mic + 2 Lines using only a Cat5e/6 cable for both power, control and audio transmissions
- Direct mixing capability of the 4 Mic/Line inputs directly to Dante without external devices

## AVDT-WALL-DT4i Rear face with European Wall Plate and Audio Flow

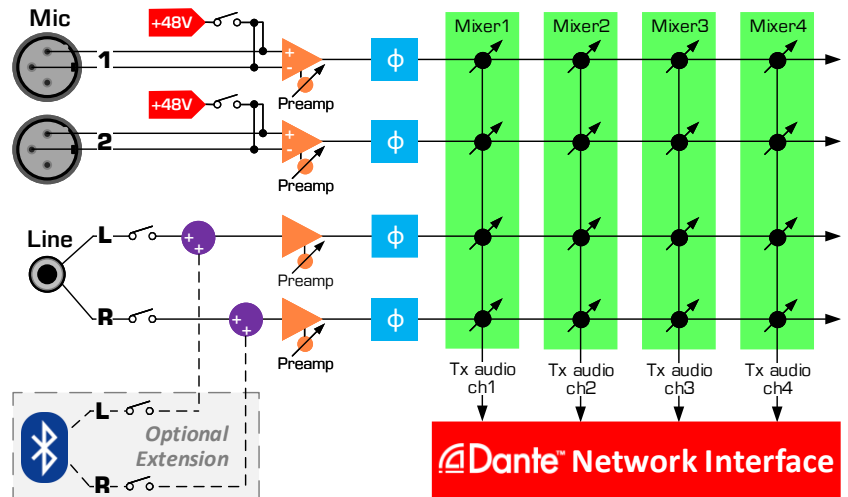
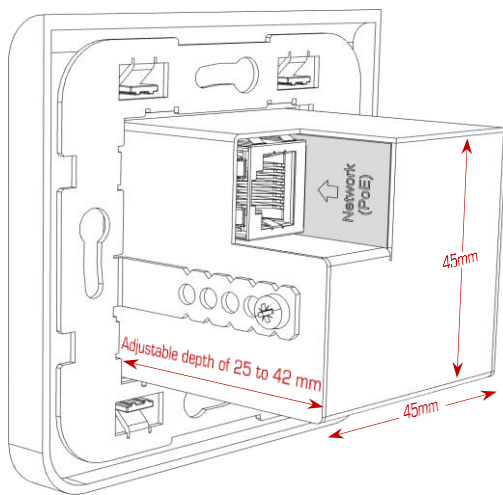

## Technical Specifications

### General

Size	45 mm x 45 mm x 50 mm main box size
Power Supply	PoE 802.3af compliant through RJ45
Storage: Temp / Humidity	-5°C to 70°C / 0% to 95% (non-condensing)
Operating: Temp / Humidity	0°C to 50°C / 5% to 90% (non-condensing)
Connectors	2x female XLR connectors for Mic/Line inputs, 1x 3.5mm mini Jack connectors for Line inputs, 10-pins tiny connector for Bluetooth extension

### Audio Inputs Specifications

Number of i/o	2x Mic/Line + 2x Analog line inputs
Sampling Frequency	44.1 kHz / 48 kHz / 88.2 kHz / 96 kHz
A/D resolution	24 bits
Input specification	Balanced Analog on XLR connectors, Unbalanced Analog on 3.5mm mini jack
Input maximum level	+24dBu on XLR connector and +12dBu on 3.5 mini jack

### Audio Inputs MIC/Line (XLR) Technical Specifications

Analog Gain Range	0 to +64dB (0.5dB step)
Input sensibility	+24dBu to -40dBu
Input Impedance	3.5 kΩ (balanced)
E.I.N. (R=1KΩ G=+40dB)	-112dBu (fs=48kHz & BW 22kHz)
Dynamic Range	> 102dB A-weighted (> 100dB un-weighted) (fs=48kHz & BW 22kHz)
THD+N (1KHz/G=0dB or G=+25dB)	< -93.2dB (0.0022%) (fs=48kHz & BW 22kHz)
Freq. response (20Hz-20kHz)	20Hz-20kHz (+/-0,8dB)
Phantom Power	+48 V (individually controllable for each channel)

### Audio Inputs Line (Mini Jack) Technical Specifications

Analog Gain Range	0 to +40dB (0.5dB step)
Input sensibility	+12dBu to -28dBu
Input Impedance	10 kΩ (unbalanced)
E.I.N. (R=1KΩ G=+40dB)	-102dBu (fs=48kHz & BW 22kHz)
Dynamic Range	> 104dB A-weighted (> 101dB un-weighted) (fs=48kHz & BW 22kHz)
THD+N (1KHz/G=0dB or G=+25dB)	< -89.2dB (0.0035%) (fs=48kHz & BW 22kHz)
Freq. response (20Hz-20kHz)	20Hz-20kHz (+/-0,4dB)

### Integration Environment

Dante Controller	AV-WALL-DT4i can be managed by Dante controller as a device with 4x TX channels that can be set to run on 24-bits audio format at a frequency of 44.1kHz / 48kHz / 88.2kHz / 96kHz
AVS-Monitor	AVS-Monitor enables to remotely set, control and monitor AV-WALL-DT4i parameters and any other AuviTran product via IP, Dante or EtherSound and provides enhanced control pages in Windows Seven/Vista/XP for 32 or 64-bit versions for AVSMonitor

## Part number

### AV-WALL-DT4i

Tiny Dante In-Wall Mic/Line interface with 2x XLR, a 3.5mm mini Jack and a local control rotative push button